

RAIL KING[®]
By M.T.H. Electric Trains

30-2242-0
30-2243-0
30-2244-0
30-2245-0

PA AA Units

Diesel Engine Set



GL071202



PA A Unit (lead) Diesel Engine

Engine Parts

NameandNumber	Part #	\$Price PerUnit	NameandNumber	Part #	\$Price PerUnit
1.) Diaphragm(black) (3rib)(26.0x50.0x10.0mm)(notchedtopcorners) (2centermountingplugs)(rubber)	FI-0000017	2.00	17.) Motor(RS-365SH) (7.9x24.0mmwormgearw/13.0mmlongthreads) (9.0x30.0mmwhite&blacktaperedflywheel) (w/blackplastictachboardbracket)	BE-0000135	25.00
2.) Shell (darkgray,lightgray,white) (poweredAunit)(NYC)(#4208)	FC-2200352	*85.00	18.) Motormount(black) (forRK3axletruck)	BI-0000029	15.00
Shell(red,yellow,white) (poweredAunit)(MKT)(#154A)	FC-2200353	*85.00	19.) Screw(yellowZinc) (M2.5x6.0mm)(roundhead)(w/lockwasher)	IA-0000001	0.15
Shell(Tuscanred,gold) (poweredAunit)(PRR)(#5752)	FC-2200354	*85.00	20.) Screw (M3x14.0mm)(roundhead)(w/lockwasher)	IA-0000012	0.15
Shell(gray,blue,white) (poweredAunit)(Wabash)(#1050)	FC-2200355	*85.00	21.) Board (Loco-Sound®)(DIESEL/ELECTRIC)	AE-0000002	*100.00
3.) Lens(clear)(portal/headlight) (3.7x5.6x2.0mm)(0.8x6.6mmlenshead) (6ribsforpressfit)	FA-0000092	2.00	22.) Screw (4/40x6.0mm)(roundhead)	IA-0000003	0.15
4.) Airhorns(nickel)(2chime)	FC-2200254	3.00	23.) Insulator(white) (washer)(3.0x6.0x3.0mm)(plastic)	ID-0000025	0.15
5.) Windows (clear) (windshieldandsidewindows)	FA-2230019	5.00	24.) Insulator(clear) (13.0x19.0x0.1mm)(singlehole)	ID-0000024	0.15
6.) Numberboard(sticker) (blackbackgroundw/whiteletters)(NYC)(#4208)	FG-2200088	0.50	25.) Screw (4/40x4.0mm)(roundhead)	IA-0000021	0.15
Numberboard(sticker) (blackbackgroundw/whiteletters)(MKT)(#154A)	FG-2200089	0.50	26.) Bracket(Aluminum) (forLoco-Sound®boards)(14.0x68.5mm) (24.5mmstep)	IH-0000190	3.00
Numberboard(sticker) (blackbackgroundw/whiteletters)(PRR)(#5752)	FG-2200090	0.50	27.) Tachboard(green) (standard)(forProto-Sound2.0®andLoco-Sound™)	AG-0000033	6.00
Numberboard (blackbackgroundw/whiteletters) (sticker)(Wabash)(#1050)	FG-2200091	0.50	28.) Screw (M3x8.0mm)(roundhead)	IA-0000035	0.15
7.) Screw (4/40x3.0mm)(roundhead)	IA-0000275	0.15	29.) Volumepot (smallvolume)(blue/greenboard)	BI-0000040	5.00
8.) Bracket(black) (metal)(12.0x35.5mm)(L-shaped)(forheadlight)	IH-0000252	3.00	30.) Spacer(black) (3.0x6.0x4.3mm)(plastic)	ID-0000071	0.15
9.) Grommet(black) (cupped)(rubber)	IH-0000144	0.50	31.) Wirenut(yellow) (blackmale12pinplug) (250.0mmlongwiresw/PCboard)	BI-4500003	0.25
10.) Bulbs(clear)(6v)(2) (70.0mmlongwiresw/blackmale2pinplug) (MKT)(#154A)(#157C) (Wabash)(#1050)(#1051)	CA-0000066	4.00	32.) Wireharness (blackmale12pinplug) (250.0mmlongwiresw/PCboard)	BC-2200070	18.00
Bulb(clear)(6v)(1) (70.0mmlongwiresw/blackmale2pinplug) (NYC)(#4208)(#4211)(PRR)(#5752)(#5754)	CA-0000067	3.00	33.) Screw (M2x4.0mm)(roundhead)	IA-0000058	0.15
11.) Pilot(dark gray) (2screwholesformountingpilot) (NYC)(#4208)(#4211)	DG-2230022	15.00	34.) Spacer(black) (hexagon shaped)(14.5mmlong) (4.0mmlongM2.5screwononeend) (M2tappedholeontheotherend)	ID-0000113	1.00
Pilot(red,yellow) (2screwholesformountingpilot) (MKT)(#154A)(#157C)	DG-2230023	15.00	35.) T-bar (black)(plastic)	IG-0000001	0.50
Pilot(Tuscanred) (2screwholesformountingpilot) (PRR)(#5752)(#5754)	DG-2230024	15.00	36.) Coupler(black) (non-operating)(34.5mmlong)(T-barmounting)	DD-4000005	3.00
Pilot(blue,white) (2screwholesformountingpilot) (Wabash)(#1050)(#1051)	DG-2230025	15.00	37.) Spring(nickel) (6.5x14.0mm)(w/0.5mmthickwire)	IE-0000022	0.50
12.) Screw (4/40x6.0mm)(flathead)	IA-0000038	0.15	38.) Washer(black) (4.5x10.0x0.6mm)	ID-0000041	0.15
13.) Screw (M3x16.0mm)(washerhead)(self-drilling)	IA-0000025	0.15	39.) E-clip (black) (3.0x8.0x0.5mm)	IF-0000002	0.15
14.) Chassis(black) (poweredAunit)(57.0x330.0mm)(stampedmetal) (holesforbatterychargerjack)	DH-2200076	*20.00	40.) Screw(nickel) (M3x6.0mm)(roundhead)	IA-0000015	0.15
15.) Rubberband	BI-4500004	0.50	41.) Insulator(black) (top)(square)(pick-up)	BD-0000026	2.00
16.) Motor(RS-365SH) (7.9x24.0mmwormgearw/13.0mmlongthreads) (9.0x30.0mmblacktaperedflywheel)	BE-0000094	25.00	42.) Tractiontire(black) (rubber)(4.0x17.0mm)	DE-0000018	0.75
			43.) Truckside(black) (rightrear/leftfront)(for3axletruck) (NYC)(#4208)(#4211)(PRR)(#5752)(#5754) (Wabash)(#1050)(#1051)	DB-2200011	9.00

*RequiresExchange
Allpartsarepricedaseach



PA A Unit (lead) Diesel Engine

Engine Parts

NameandNumber	Part #	\$Price PerUnit	NameandNumber	Part #	\$Price PerUnit
43.) Truckside(silver) (rightrear/leftfront)(for3axletruck) (MKT)(#154A)(#157C)	DB-2200013	9.00	NS.) Wireharness (150.0mmlongred&blackwiresw/eyelets) (blackwireshieldonwires)(forpick-up)	BC-0000165	4.00
44.) Truckside(black) (leftrear/rightfront)(for3axletruck) (NYC)(#4208)(#4211)(PRR)(#5752)(#5754) (Wabash)(#1050)(#1051)	DB-2200012	9.00			
Truckside(silver) (leftrear/rightfront)(for3axletruck) (MKT)(#154A)(#157C)	DB-2200014	9.00			
45.) Truck(black) (powered)(3axle)(2holestappedformountingpilot) (2 M2.5 holes tappedformountingPCboardunder coupler)(trucksidemountfromtop)	DA-2000028	*35.00			
46.) Bracket(black) (speaker)(12.0x9.7mm)(5.0mmstep) (roundedendbymountinghole)	IH-0000322	1.00			
47.) Speaker (Star)(FR-05004-A0422)(8ohms)(MAX0.5watt)	BF-0000028	8.95			
48.) Gasket(black) (speaker)(foam)(46.0x51.0mm)(4.5mmthick) (for50.0mmspeakers)	IB-0000011	1.00			
49.) Fuel tank(black) (w/slottedholesforspeaker)(tappedfor4/40screws) (4mountingpostsforspeaker) (NYC)(#4208)(PRR)(#5752)(Wabash)(#1050)	FC-2200349	*20.00			
Fuel tank (red) (w/slottedholesforspeaker)(tappedfor4/40screws) (4mountingpostsforspeaker)(MKT)(#154A)	FC-2200356	*20.00			
50.) Nut(nickel)(2.5x5.0x7.0mm)	IC-0000008	0.50			
51.) Insulator(black) (pick-up)(bottom)(square)(flat)	BD-0000006	2.00			
52.) Pick-up (8.0x11.0mmroller)(24.0mmlong)	BD-0000013	5.00			
53.) Coupler(black) (mechanical)(44.6mmlong)(T-barmounting) (armaturepinis25.0mmoutfromend)	DD-0000009	3.00			
54.) Armature(black) (37.8mmlong)(T-barmounting)(3.3mmcouplerpin) (thumbtackis22.0mmoutfromend)(newdesign) (armaturepinis34.3mmoutfromend)	DD-0000046	2.00			
55.) Spring(nickel) (6.4x10.0mm)(w/0.5mmthickwire)	IE-0000070	0.50			
56.) Washer(black) (cupshapedforspringtofitin)(4.6x8.5x2.0mm) (inside7.0x1.0mm)(plastic)	ID-0000060	0.15			
57.) Wirestrap(black) (metal)(small)	IH-0000012	1.00			
58.) Screw (M3x6.0mm)(roundhead)	IA-0000016	0.15			
59.) Speakercone(black) (plastic)(11.0x38.0mm)(shavedon2sides)	BF-0000014	2.00			
NS.) Wireharness (blackmale7pinplug) (260.0mmlongwiresw/tachboard) (80.0mmlongred&blackwires)	BC-0000183	10.00			
NS.) Wireharness (blackmale5pinplug)(formotors) (175.0mm&130.0mmlongyellow&whitewires)	BC-2200064	4.00			
NS.) Wireharness(forspeaker) (70.0mmlongwiresw/whitemale2pinplug)	BC-2100027	3.00			

*RequiresExchange
Allpartsarepricedaseach

PA A Unit (lead) Diesel Engine Engine Parts

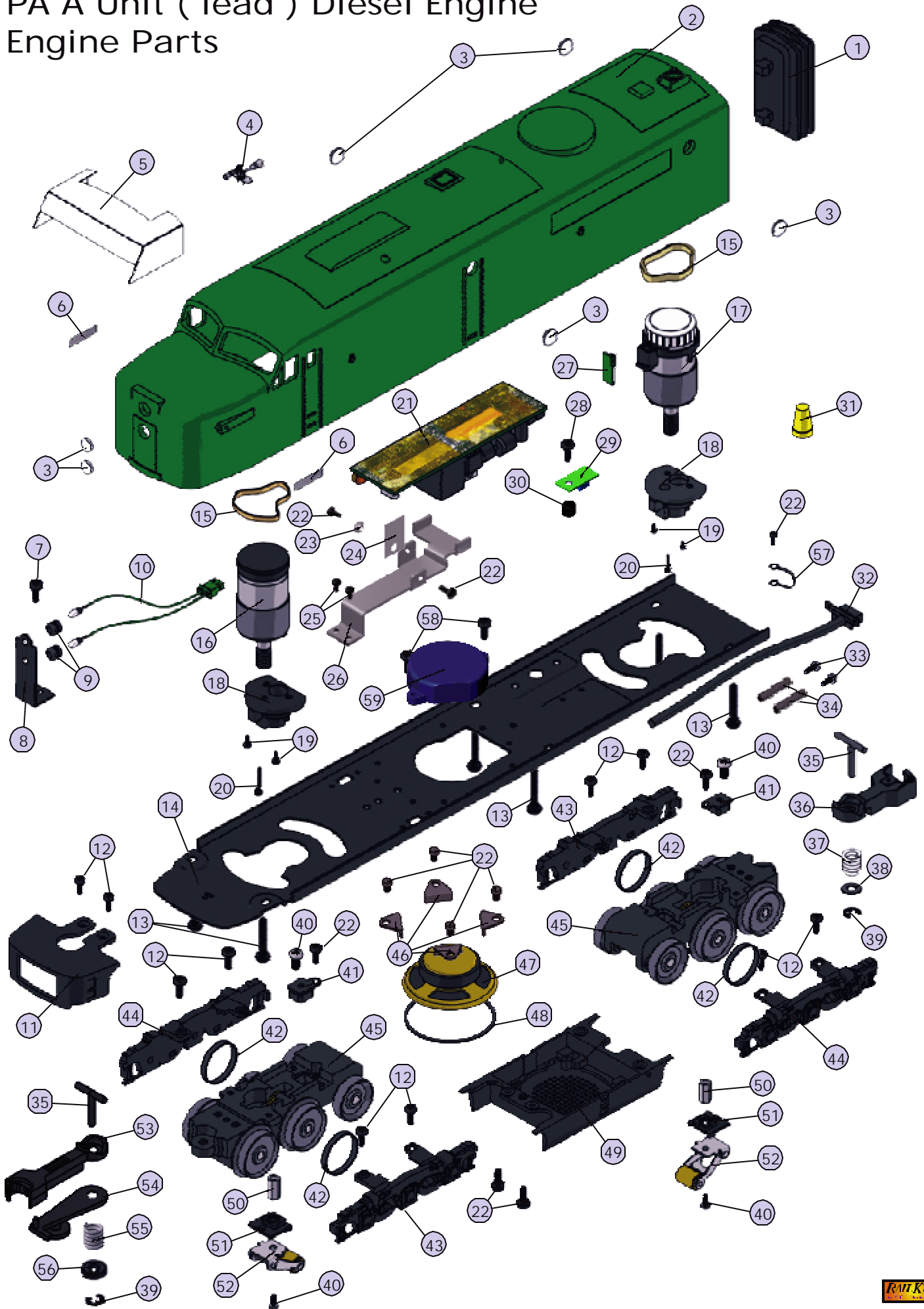

PA A Unit (trailing) Diesel Engine

Engine Parts

NameandNumber	Part #	\$Price PerUnit	NameandNumber	Part #	\$Price PerUnit
1.) Diaphragm(black) (3rib)(26.0x50.0x10.0mm)(notchedtopcorners) (2centermountingplugs)(rubber)	FI-0000017	2.00	21.) Washer(black) (4.5x10.0x0.6mm)	ID-0000041	0.15
2.) Shell (darkgray,lightgray,white) (non-poweredAunit)(NYC)(#4211)	FC-2200357	*85.00	22.) E-clip (black) (3.0x8.0x0.5mm)	IF-0000002	0.15
Shell(red,yellow,white) (non-poweredAunit)(MKT)(#157C)	FC-2200358	*85.00	23.) Screw (4/40x6.0mm)(flathead)	IA-0000038	0.15
Shell(Tuscanred,gold) (non-poweredAunit)(PRR)(#5754)	FC-2200359	*85.00	24.) Truckside(black) (rightrear/leftfront)(for3axletruck) (NYC)(#4208)(#4211)(PRR)(#5752)(#5754) (Wabash)(#1050)(#1051)	DB-2200011	9.00
Shell(gray,blue,white) (non-poweredAunit)(Wabash)(#1051)	FC-2200360	*85.00	Truckside(silver) (rightrear/leftfront)(for3axletruck) (MKT)(#154A)(#157C)	DB-2200013	9.00
3.) Lens(clear)(portal/headlight) (3.7x5.6x2.0mm)(0.8x6.6mmlenshead) (6ribsforpressfit)	FA-0000092	2.00	25.) Truckside(black) (leftrear/rightfront)(for3axletruck) (NYC)(#4208)(#4211)(PRR)(#5752)(#5754) (Wabash)(#1050)(#1051)	DB-2200012	9.00
4.) Airhorns(nickel)(2chime)	FC-2200254	3.00	Truckside(silver) (leftrear/rightfront)(for3axletruck) (MKT)(#154A)(#157C)	DB-2200014	9.00
5.) Numberboard(sticker) (blackbackgroundw/whiteletters)(NYC)(#4211)	FG-2200092	0.50	26.) Truck (black)(non-powered) (3axle)(2holes tappedformountingpilot) (2tappedholesundercouplermountforPCboard)	DA-2000026	*35.00
Numberboard(sticker) (blackbackgroundw/whiteletters)(MKT)(#157C)	FG-2200093	0.50	27.) Screw (4/40x6.0mm)(roundhead)	IA-0000003	0.15
Numberboard(sticker) (blackbackgroundw/whiteletters)(PRR)(#5754)	FG-2200094	0.50	28.) Fuel tank(black) (knowholesforspeaker)(4mountingholes) (3mountingposts)(4speaker mountingposts) (NYC)(#4211)(PRR)(#5752)(Wabash)(#1051)	FC-2200340	*20.00
Numberboard (blackbackgroundw/whiteletters) (sticker)(Wabash)(#1051)	FG-2200095	0.50	Fuel tank (red) (knowholesforspeaker)(4mountingholes) (3mountingposts)(4speaker mountingposts) (MKT)(#157C)	FC-2200345	*20.00
6.) Windows (clear) (windshieldandsidewindows)	FA-2230019	5.00	29.) Pilot(dark gray) (2screwholesformountingpilot) (NYC)(#4208)(#4211)	DG-2230022	15.00
7.) Screw (4/40x3.0mm)(roundhead)	IA-0000275	0.15	Pilot(red,yellow) (2screwholesformountingpilot) (MKT)(#154A)(#157C)	DG-2230023	15.00
8.) Bracket(black) (metal)(12.0x35.5mm)(L-shaped)(forheadlight)	IH-0000252	3.00	Pilot(Tuscanred) (2screwholesformountingpilot) (PRR)(#5752)(#5754)	DG-2230024	15.00
9.) Grommet(black) (cupped)(rubber)	IH-0000144	0.50	Pilot(blue,white) (2screwholesformountingpilot) (Wabash)(#1050)(#1051)	DG-2230025	15.00
10.) Bulbs(clear)(6v)(2) (70.0mmlongwiresw/blackmale2pinplug) (MKT)(#154A)(#157C) (Wabash)(#1050)(#1051)	CA-0000066	4.00	30.) Armature(black) (37.8mmlong)(T-barmounting)(3.3mmcouplerpin) (thumbtackis22.0mmloutfromend)(newdesign) (armaturepinis34.3mmloutfromend)	DD-0000046	2.00
Bulb(clear)(6v)(1) (70.0mmlongwiresw/blackmale2pinplug) (NYC)(#4208)(#4211)(PRR)(#5752)(#5754)	CA-0000067	3.00	31.) Spring(nickel) (6.4x10.0mm)(w/0.5mmthickwire)	IE-0000070	0.50
11.) Bolt(black) (8/32x15.0mm)(6.0x8.0mmoversizedshank) (1.8x10.0mmslottedhead)	IA-0000088	1.00	32.) Washer(black) (cupshapedforspringtofitin)(4.6x8.5x2.0mm) (inside7.0x1.0mm)(plastic)	ID-0000060	0.15
12.) Spring(nickel) (8.0x12.0mm)(w/0.7thickwire)	IE-0000026	0.50			
13.) Chassis(black)(stampedmetal) (non-poweredAunit)(57.0x330.0mm) (has2extraholesforfuel tankmountingposts)	DH-2200075	*20.00			
14.) Wirestrap(black) (metal)(small)	IH-0000012	1.00			
15.) Wireharness (blackmale10pinplug) (325.0mmlongwiresw/greenfemale2pinplug)	BC-2200071	10.00			
16.) Screw (M3x16.0mm)(washerhead)(self-drilling)	IA-0000025	0.15			
17.) T-bar (black)(plastic)	IG-0000001	0.50			
18.) Coupler(black) (non-operating)(34.5mmlong)(T-barmounting)	DD-4000005	3.00			
19.) Coupler(black) (mechanical)(44.6mmlong)(T-barmounting) (armaturepinis25.0mmloutfromend)	DD-0000009	3.00			
20.) Spring(nickel) (6.5x14.0mm)(w/0.5mmthickwire)	IE-0000022	0.50			

*RequiresExchange
Allpartsarepricedaseach



PA A Unit (trailing) Diesel Engine Engine Parts

