

RAIL KING[®]
By M.T.H. Electric Trains

30-2218-1

30-2219-1

PA AA Units

Diesel Engine Set



GL070902

REV.070902



PA A Unit (lead) Diesel Engine

Engine Parts

NameandNumber	Part #	\$Price PerUnit	NameandNumber	Part #	\$Price PerUnit
1.) Diaphragm(black) (3rib)(26.0x50.0x10.0mm)(notchedtopcorners) (2centermountingplugs)(rubber)	FI-0000017	2.00	25.) Bracket(Aluminum) (forProto-Sound®2.0boards)(15.0x44.0mm) (10.5mmstep)(tappedfor6/32screw)	IH-0000237	3.00
2.) Shell(yellow,gray,red,green) (poweredAunit)(UP)(#604)	FC-2200346	*85.00	26.) Screw (6/32x12.0mm)(roundhead)	IA-0000103	0.15
Shell (black,maroon,gray,yellow) (poweredAunit)(EL)(#856)	FC-2200347	*85.00	27.) Tachboard(green) (standard)(forProto-Sound2.0®andLoco-Sound™)	AG-0000033	6.00
3.) Lens(clear)(portal/headlight) (3.7x5.6x2.0mm)(0.8x6.6mmlenshead) (6ribsforpressfit)	FA-0000092	2.00	28.) Screw (M3x8.0mm)(roundhead)	IA-0000035	0.15
4.) Airhorns(nickel)(2chime)	FC-2200254	3.00	29.) Volumepot (smallvolumepot)(bluew/greenboard)	BI-0000040	5.00
5.) Windows (clear) (windshieldandsidewindows)	FA-2230019	5.00	30.) Spacer(black) (3.0x6.0x4.3mm)(plastic)	ID-0000071	0.15
6.) Numberboard(sticker) (blackbackground w/ whiteletters)(UP)(#604)	FG-2200084	0.50	31.) Screw (4/40x6.0mm)(roundhead)	IA-0000003	0.15
Numberboard(sticker) (whitebackgroundw/blackletters)(EL)(#856)	FG-2200085	0.50	32.) Insulator(white) (washer)(3.0x6.0x3.0mm)(plastic)	ID-0000025	0.15
7.) Lens(clear)(portal/headlight) (3.7x5.6x2.0mm)(0.8x6.6mmlenshead)	FA-0000092	2.00	33.) Voltageregulator (LM2937ET)	AG-0000032	3.00
8.) Screw (4/40x3.0mm)(roundhead)	IA-0000275	0.15	34.) Insulator(clear) (13.0x19.0x0.1mm)(singlehole)	ID-0000024	0.15
9.) Bulbs(clear)(6v)(2) (70.0mmlongwiresw/blackmale2pinplug) (UP)(#604)(#602)	CA-0000066	4.00	35.) Screw (M3x4.0mm)(roundhead)	IA-0000010	0.15
Bulb(clear)(6v)(1) (70.0mmlongwiresw/blackmale2pinplug) (EL)(#856)(#860)	CA-0000067	3.00	36.) Batteryleads (135.0mmlongwiresw/smallblackmale2pinplug)	BC-0000182	3.00
10.) Grommet(black) (cupped)(rubber)	IH-0000144	0.50	37.) Battery(white) (8.4volts)(re-chargeable)(nickel-cadium)	BG-4000001	10.00
11.) Bracket(black) (metal)(12.0x35.5mm)(L-shaped)(forheadlight)	IH-0000252	3.00	38.) Bracket(black) (battery)(verticalmount)(plastic)	IH-0000042	4.00
12.) Screw (4/40x6.0mm)(flathead)	IA-0000038	0.15	39.) Wireharness (PCboardw/blackfemale10pinplug) (180.0mmlongwiresw/blue&greenmale2pinplugs)	BC-2200060	12.00
13.) Wirestrap(black) (metal)(small)	IH-0000012	1.00	40.) Screw (M2x18.0mm)(roundhead)	IA-0000095	0.15
14.) Pilot(gray) (2screwholesformountingpilot) (UP)(#604)(#602)	DG-2230020	15.00	41.) Spacer(black) (2.0x4.5x14.5mm)(metal)	ID-0000050	0.50
Pilot(black) (2screwholesformountingpilot) (EL)(#856)(#860)	DG-2230021	15.00	42.) T-bar (black)(plastic)	IG-0000001	0.50
15.) Chassis(black) (poweredAunit)(57.0x330.0mm)(stampedmetal)	DH-2200074	*20.00	43.) Coupler(black) (non-operating)(34.5mmlong)(T-barmounting)	DD-4000005	3.00
16.) Rubberband	BI-4500004	0.50	44.) Spring(nickel) (6.5x14.0mm)(w/0.5mmthickwire)	IE-0000022	0.50
17.) Motor(RS-365SH) (7.9x24.0mmlongwormgearw/13.0mmlongthreads) (9.0x30.0mmlongblacktaperedflywheel)	BE-0000094	25.00	45.) Washer(black) (4.5x10.0x0.6mm)	ID-0000041	0.15
18.) Motor(RS-365SH) (7.9x24.0mmlongwormgearw/13.0mmlongthreads) (9.0x30.0mmlongwhite&blacktaperedflywheel) (w/blackplasticdashboardbracket)	BE-0000135	25.00	46.) E-clip (black) (3.0x8.0x0.5mm)	IF-0000002	0.15
19.) Motormount(black) (forRK3axletruck)	BI-0000029	15.00	47.) Screw (M3x16.0mm)(washerhead)(self-drilling)	IA-0000025	0.15
20.) Screw(yellowZinc) (M2.5x6.0mm)(roundhead)(w/lockwasher)	IA-0000001	0.15	48.) Screw(nickel) (M3x6.0mm)(roundhead)	IA-0000015	0.15
21.) Screw (M3x14.0mm)(roundhead)(w/lockwasher)	IA-0000012	0.15	49.) Insulator(black) (top)(square)(pick-up)	BD-0000026	2.00
22.) Wirenut(yellow)	BI-4500003	0.25	50.) Tractiontire(black) (rubber)(4.0x17.0mm)	DE-0000018	0.75
23.) Boards(Proto-Sound®2.0) (w/Rommemory)(5vboard)	AE-0000001	*200.00	51.) Truck(black) (powered)(3axle)(2holestappedformountingpilot) (2holestappedformountingPCboard undercoupler) (trucksidemountfromtop)	DA-2000027	*35.00
24.) Screw (4/40x4.0mm)(roundhead)	IA-0000021	0.15	52.) Truck(black) (powered)(3axle)(2holestappedformountingpilot) (2holestappedformountingPCboard undercoupler) (trucksidemountfromtop)	DA-2000027	*35.00

*RequiresExchange

Allpartsarepricedaseach



PA A Unit (lead) Diesel Engine

Engine Parts

NameandNumber	Part #	\$Price PerUnit
53.) Bracket(black) (speaker)(metal)(9.0x9.5mm)(3.0mmstep) (roundedcornersonmountingend)	IH-0000002	1.00
54.) Speaker (Star)(FR-05004-B0422)(16ohms)(MAX0.5watt)	BF-0000027	8.95
55.) Gasket(black) (speaker)(foam)(46.0x51.0mm)(4.5mmthick) (for50.0mmspeakers)	IB-0000011	1.00
56.) Fuel tank(gray) (w/slottedholesforspeaker)(tappedfor4/40screws) (4mountingpostsforspeaker)(UP)(#604)	FC-2200348	*20.00
Fuel tank(black) (w/slottedholesforspeaker)(tappedfor4/40screws) (4mountingpostsforspeaker)(EL)(#856)	FC-2200349	*20.00
57.) Truckside(black) (rightrear/leftfront)(for3axletruck) (EL)(#856)(#860)(Bunit)	DB-2200011	9.00
Truckside(silver) (rightrear/leftfront)(for3axletruck) (UP)(#602)(#604)(#607B)	DB-2200013	9.00
58.) Truckside(black) (leftrear/rightfront)(for3axletruck) (EL)(#856)(#860)(Bunit)	DB-2200012	9.00
Truckside(silver) (leftrear/rightfront)(for3axletruck) (UP)(#602)(#604)(#607B)	DB-2200014	9.00
59.) Nut(nickel)(2.5x5.0x7.0mm)	IC-0000008	0.50
60.) Insulator(black) (pick-up)(bottom)(square)(flat)	BD-0000006	2.00
61.) Pick-up (8.0x11.0mmroller)(24.0mmlong)	BD-0000013	5.00
62.) Proto-Coupler®(black) (Proto-Coupler®2.0)(51.0mmlong)	DD-0000032	10.00
NS.) Wireharness (blackmale12pinplug)	BC-2200063	15.00
NS.) Wireharness (blackmale7pinplug) (195.0mmlongwiresw/tachboard) (70.0mmlongred&blackwires)	BC-2200021	10.00
NS.) Wireharness (blackmale5pinplug)(formotors) (175.0mm&130.0mmlongyellow&whitewires)	BC-2200064	4.00
NS.) Wireharness(forspeaker) (70.0mmlongwiresw/whitemale2pinplug)	BC-2100027	3.00
NS.) Wireharness (105.0mmlongwiresw/blackmale2pinplug) (w/blackprotectivewiresshield)(forProto-Coupler®)	BC-0000118	2.00
NS.) Wireharness (110.0mmlongredwirew/eyelet)(forpick-up)	BC-2200052	2.00
NS.) Wireharness (110.0mmlongblackwirew/eyelet)(forpick-up)	BC-2200053	2.00

*RequiresExchange
Allpartsarepricedaseach

PA A Unit (lead) Diesel Engine Engine Parts

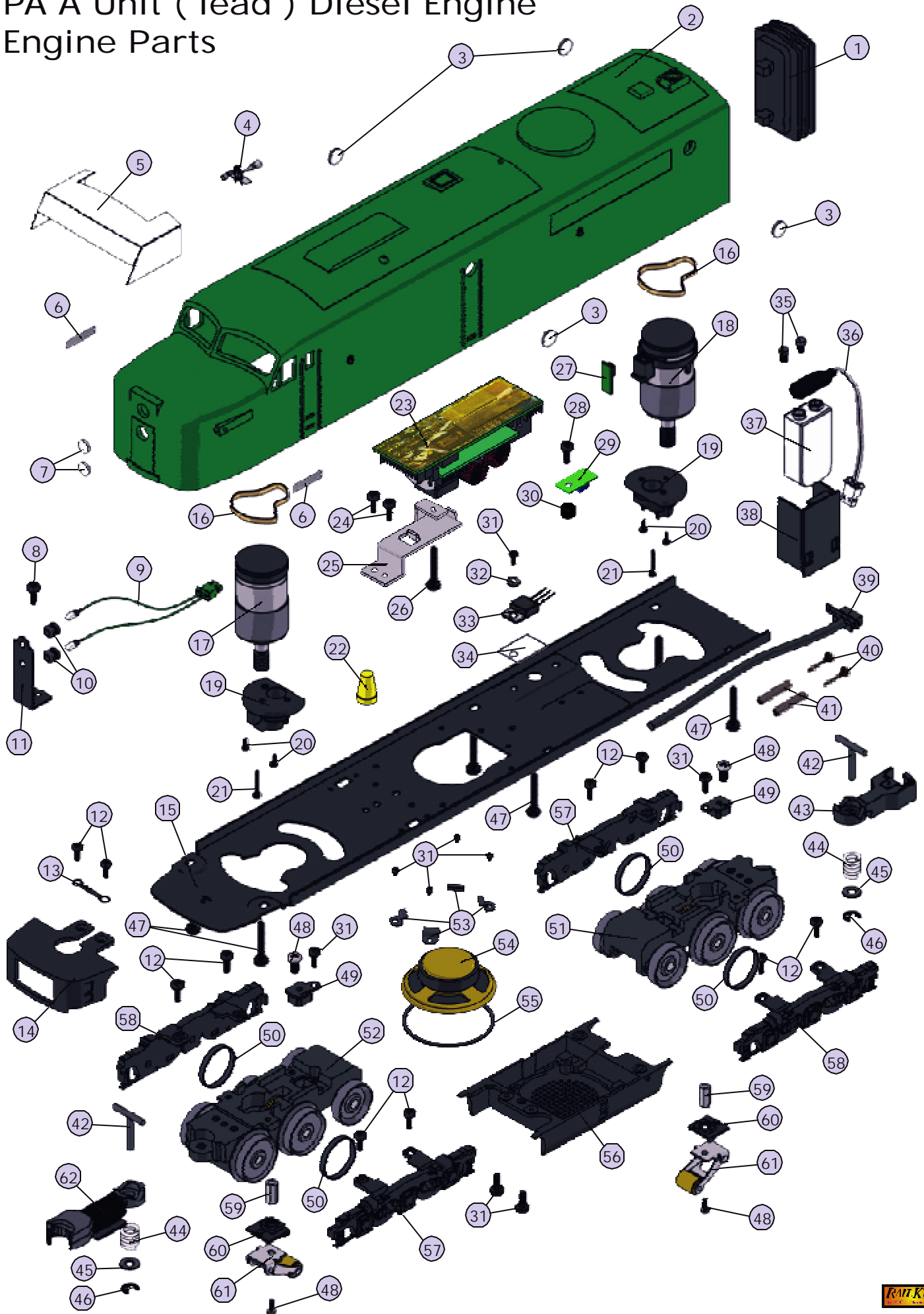

PA A Unit (trailing) Diesel Engine

Engine Parts

NameandNumber	Part #	\$Price PerUnit	NameandNumber	Part #	\$Price PerUnit
1.) Diaphragm(black) (3rib)(26.0x50.0x10.0mm)(notchedtopcorners) (2centermountingplugs)(rubber)	FI-0000017	2.00	24.) Truckside(silver) (rightrear/leftfront)(for3axletruck) (UP)(#602)(#604)(#607B)	DB-2200013	9.00
2.) Shell(yellow,gray,red,green) (non-poweredAunit)(UP)(#602)	FC-2200350	*85.00	25.) Truckside(black) (leftrear/rightfront)(for3axletruck) (EL)(#856)(#860)(Bunit)	DB-2200012	9.00
Shell (black,maroon,gray,yellow) (non-poweredAunit)(EL)(#860)	FC-2200351	*85.00	Truckside(silver) (leftrear/rightfront)(for3axletruck) (UP)(#602)(#604)(#607B)	DB-2200014	9.00
3.) Lens(clear)(portal/headlight) (3.7x5.6x2.0mm)(0.8x6.6mmlenshead) (6ribsforpressfit)	FA-0000092	2.00	26.) Truck (black)(non-powered) (3axle)(2holes tappedformountingpilot) (2tappedholesundercouplermountforPCboard)	DA-2000026	*35.00
4.) Airhorns(nickel)(2chime)	FC-2200254	3.00	27.) Screw (4/40x6.0mm)(roundhead)	IA-0000003	0.15
5.) Numberboard(sticker) (blackbackgroundw/whiteletters)(UP)(#602)	FG-2200086	0.50	28.) Fuel tank (gray) (knowholesforspeaker)(4mountingholes) (3mountingposts)(4speakersmountingposts) (UP)(#602)(#607B)	FC-2200339	*20.00
Numberboard(sticker) (whitebackgroundw/blackletters)(EL)(#860)	FG-2200087	0.50	Fuel tank(black) (knowholesforspeaker)(4mountingholes) (3mountingposts)(4speakersmountingposts) (EL)(#860)(Bunit)	FC-2200340	*20.00
6.) Windows (clear) (windshieldandsidewindows)	FA-2230019	5.00	29.) Pilot(gray) (2screwholesformountingpilot) (UP)(#604)(#602)	DG-2230020	15.00
7.) Screw (4/40x3.0mm)(roundhead)	IA-0000275	0.15	Pilot(black) (2screwholesformountingpilot) (EL)(#856)(#860)	DG-2230021	15.00
8.) Bracket(black) (metal)(12.0x35.5mm)(L-shaped)(forheadlight)	IH-0000252	3.00	*RequiresExchange Allpartsarepricedaseach		
9.) Grommet(black) (cupped)(rubber)	IH-0000144	0.50			
10.) Bulbs(clear)(6v)(2) (70.0mmlongwiresw/blackmale2pinplug) (UP)(#604)(#602)	CA-0000066	4.00			
Bulb(clear)(6v)(1) (70.0mmlongwiresw/blackmale2pinplug) (EL)(#856)(#860)	CA-0000067	3.00			
11.) Bolt(black) (8/32x15.0mm)(6.0x8.0mmoversizedshank) (1.8x10.0mmslottedhead)	IA-0000088	1.00			
12.) Spring(nickel) (8.0x12.0mm)(w/0.7thickwire)	IE-0000026	0.50			
13.) Chassis(black)(stampedmetal) (non-poweredAunit)(57.0x330.0mm) (has2extraholesforfueltankmountingposts)	DH-2200075	*20.00			
14.) Wirestrap(black) (metal)(small)	IH-0000012	1.00			
15.) Wireharness (blackmale10pinplug) (410.0mmlongwiresw/bluefemale2pinplug) (420.0mmlongwirew/yellowfemale2pinplug)	BC-2200062	10.00			
16.) Screw (M3x16.0mm)(washerhead)(self-drilling)	IA-0000025	0.15			
17.) T-bar (black)(plastic)	IG-0000001	0.50			
18.) Coupler(black) (non-operating)(34.5mmlong)(T-bar mounting)	DD-4000005	3.00			
19.) Proto-Coupler®(black) (Proto-Coupler®2.0)(51.0mmlong)	DD-0000032	10.00			
20.) Spring(nickel) (6.5x14.0mm)(w/0.5mmthickwire)	IE-0000022	0.50			
21.) Washer(black) (4.5x10.0x0.6mm)	ID-0000041	0.15			
22.) E-clip (black) (3.0x8.0x0.5mm)	IF-0000002	0.15			
23.) Screw (4/40x6.0mm)(flathead)	IA-0000038	0.15			
24.) Truckside(black) (rightrear/leftfront)(for3axletruck) (EL)(#856)(#860)(Bunit)	DB-2200011	9.00			

PA A Unit (trailing) Diesel Engine Engine Parts

