



Stock Car

20-90006-A
20-90008-B
20-90016-E
20-90021-C
20-90027-E
20-94501
20-94502
20-94503
20-94504
20-94505



Rev. 3-10-01

Stock Car

Car Parts

Name and Number		Part #	\$Price Per Unit	Name and Number		Part #	\$Price Per Unit
1	Door guide (top) (Red) GN #55924/ SO #45778/PRR #130554	HB-6100001	2.00	(Red & Silver) PRR #130554	HB-6100032		
	(Yellow) UP #47456D/ CNW #4536	HB-6100002 HB-6100003		(Yellow & Green) CNW# 14536	HB-6100033		
	(Brown) C&S (BNSF #7064)	HB-6100004		(Brown) C&S(BNSF #7064)	HB-6100034		
	(Black) CGW #823	HB-6100005		(Black) CGW #823	HB-6100035		
	(Orange) NH #23702	HB-6100006		(Black & Orange) NH #23702	HB-6100036		
	(Orange) D&R G # 39431, # 39433	HB-6100042		(Black, Orange & Silver) D&R G #39431	HB-6100050		
	(Silver) N&S #33174, # 33176	HB-6100043		(Black, Orange & Silver) D&R G #39433	HB-6100051		
2	Door guide (bottom) (Red) PRR #30554/ GN #55924/ SOU #45778	HB-6100007		(Silver) N&S #33174	HB-6100052		
	(Yellow) U P #47456D	HB-6100008		(Silver) N&S #33176	HB-6100053		
	(Green) CNW #14536	HB-6100009		8 Screw (M2.6x6mm) (roundhead)(plastic cutting threads)	IA-0000206	0.15	
	(Brown) C&S (BNSF #7064)	HB-6100010		9 Catwalk		4.00	
	(Black) CGW #823/NH #23702	HB-6100011		(Red) GN #55924	HB-6100037		
	(Orange) D&R G #39431, 39433	HB-6100044		(Silver) SOU #45778	HB-6100038		
	(Silver) N&S #33174, 33176	HB-6100045		UP #47456D/ PRR #130554/ D&R G #39431, #39433/ N&S #33174, # 33176			
3	Screw (M2.6x4mm) (roundhead)(plastic cutting threads)	IA-0000208	0.15	(Green) CNW #14536	HB-6100039		
4	Door (Red) GN #55924/ SOU #45778	HB-6100012	4.00	(Brown) C&S #7064	HB-6100040		
	(Yellow) UP #47456D	HB-6100013		(Black) CGW #823	HB-6100041		
	(White) PRR #130554	HB-6100014		NH #23702			
	(Yellow & Green) CNW #14536	HB-6100015		10 Brake wheel (black)	HE-4100033	1.00	
	(Brown) C&S (BNSF #7064)	HB-6100016		11 Chassis (black)	HD-0100065	*12.00	
	(Black) CGW #823	HB-6100017		12 Screw (M3x8mm)(roundhead) (plastic cutting threads)	IA-0000204	0.15	
	(Orange) NH #23702	HB-6100018		13 Screw (M3x5mm)(washer head)	IA-0000268	0.15	
	(Orange) D&R G #39431, #39433	HB-6100046		14 Washer (6x10x0.9mm)	ID-0000064	0.15	
	(Silver) N&S #33174, #33176	HB-6100047		15 Truck (2 axle) (black truck sides)(w/ truck side springs)	DA-0100006	6.00	
5	Ladder (side) (Red) GN #55924/ SOU #45778/ PRR #130554	HB-6100019	2.00	16 Undercarriage detail (black)	HD-0100066	8.00	
	(Yellow) UP #47456D	HB-6100020		17 Screw (M2.5x6mm)(flathead)	IA-0000178	0.15	
	(Green) CNW #14536	HB-6100021		18 Spring (truck side) (2.5x5x0.2mm)	IE-0000033	0.25	
	(Brown) C&S (BNSF #7064)	HB-6100022		19 Screw (M2x4mm)(washer head)	IA-0000080	0.15	
	(Black) CGW #823/ NH #23702	HB-6100023		20 Coupler	DD-0000015	3.00	
	(Silver) N&S #33174, #33176	HB-6100048		21 Spring (centering)	IE-0000036	0.50	
	(Orange) D&R G #39431, #39433	HB-6100049		22 Armature	DD-0000014	1.00	
	(Red) GN #55924/ SOU #45778/PRR #130554	HB-6100024		23 Insulator washer (clear) (5x10x0.3mm)	ID-0000065	0.15	
	(Silver) UP #47456D N&S #33174, #33176	HB-6100025		24 Spring (nickel) (6x8mm)(w/ 0.4mm thick wire)	IE-0000035	0.50	
	(Green) CNW #14536	HB-6100026					
	(Brown) C&S (BNSF #7064)	HB-6100027					
	(Black) NH #23702/ CGW #823/ D&R G #39431, # 39433	HB-6100028					
6	Shell		*25.00				
	(Red) GN #55924	HB-6100029					
	(Red & Silver) SOU #45778	HB-6100030					
	(Yellow & Silver) UP #47456D	HB-6100031					

*Requires Exchange
All parts are priced as each



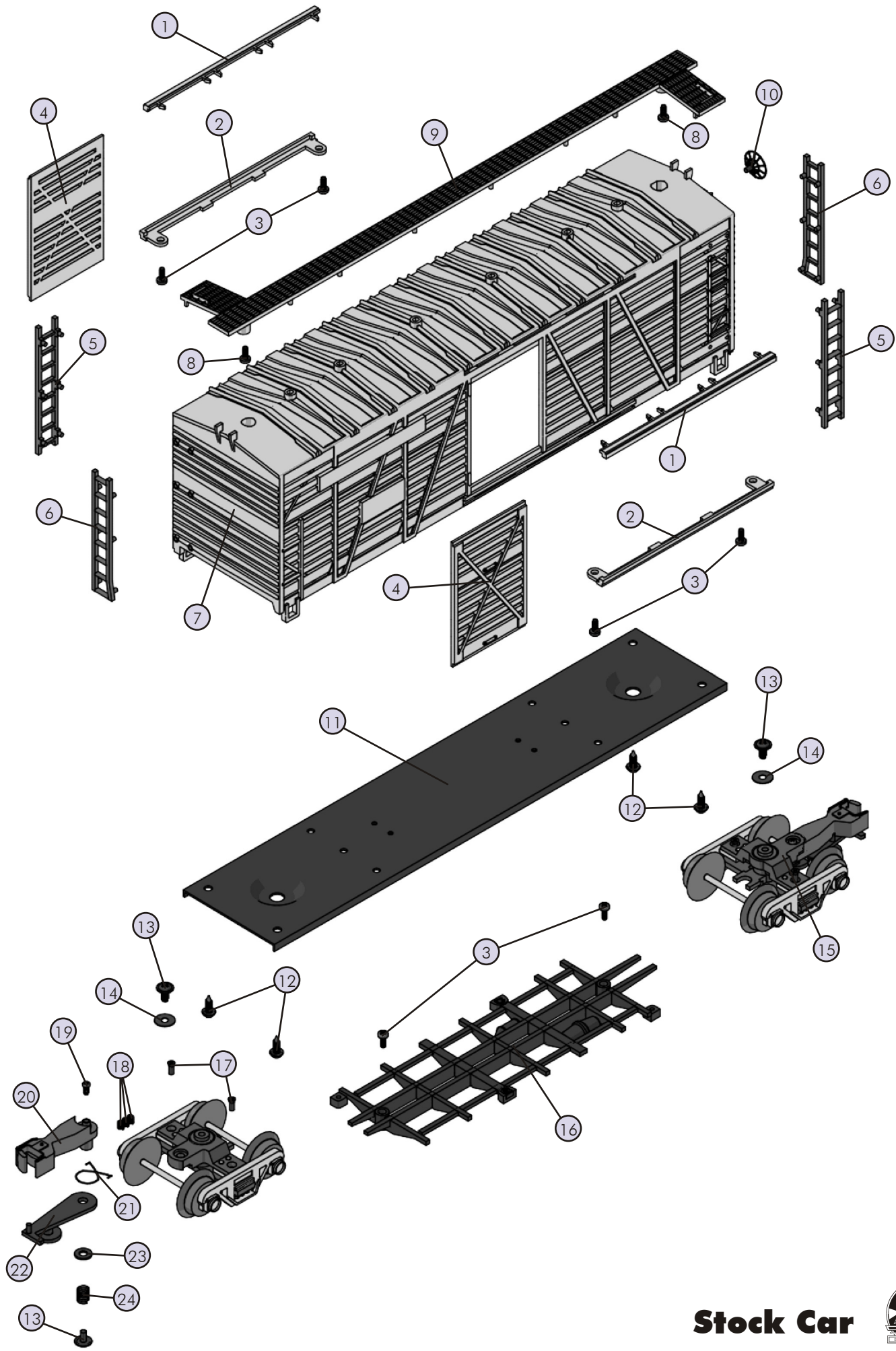

Stock Car

